

12 36225 DBAG BR 232 =

Pos. Nr. Pos.no.	Beschreibung Description	Art.-Nr. Art.no.	Preisgruppe Price bracket
1	Motor Motor	85125	55
2	Kardanschale Cardan bearing	87104	3
3	Kardanschale 8,0 mm Cardan bearing 8,0mm	87152	2
4	Steckplatine Printed	87829	20
5	Platine komplett Printed circuit assembly	87859	38
6	Lichtleitstäbesatz Light transmission bar set	107656	10
7	Drahtlampe T3/4 16V 30mA Light bulb T3/4 16V 30mA	108616	10
8	Fenstersatz Window set	109326	18
9	TS - Führerstand + Trittbrett Part set driver cab + running board	109327	10
10	Lichtabdeckungssatz Light cover set stamped	109328	6
11	GF-Schraube M2x5 GF-Screw M2x5	114966	2
12	Gehäuse komplett Betr. Nr. 232 589-2 Body assembly No. 232 589-2	127970	60
13	Hochleistungspuffer High power Buffer	124455	2
14	Lüfter hoch lackiert Ventilator coated	124456	5
15	TS - Gehäuse Part set body	127971	10

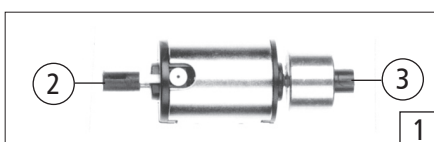

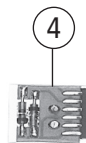
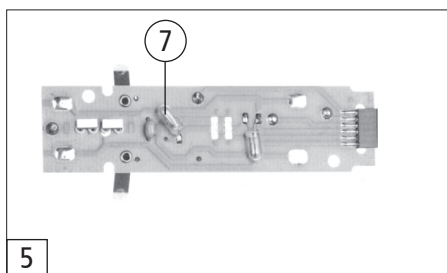
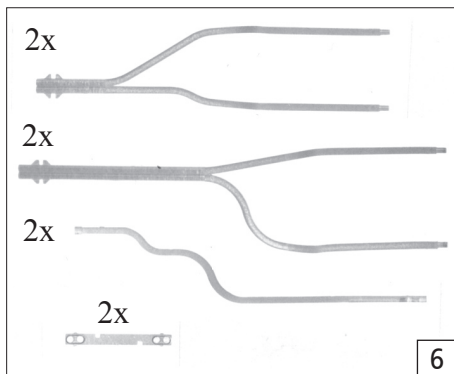
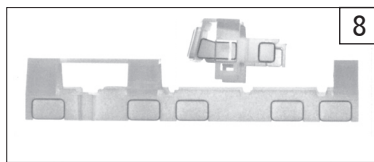
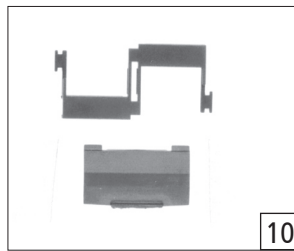
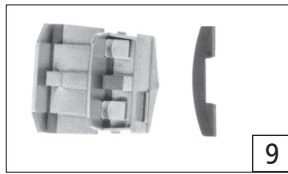
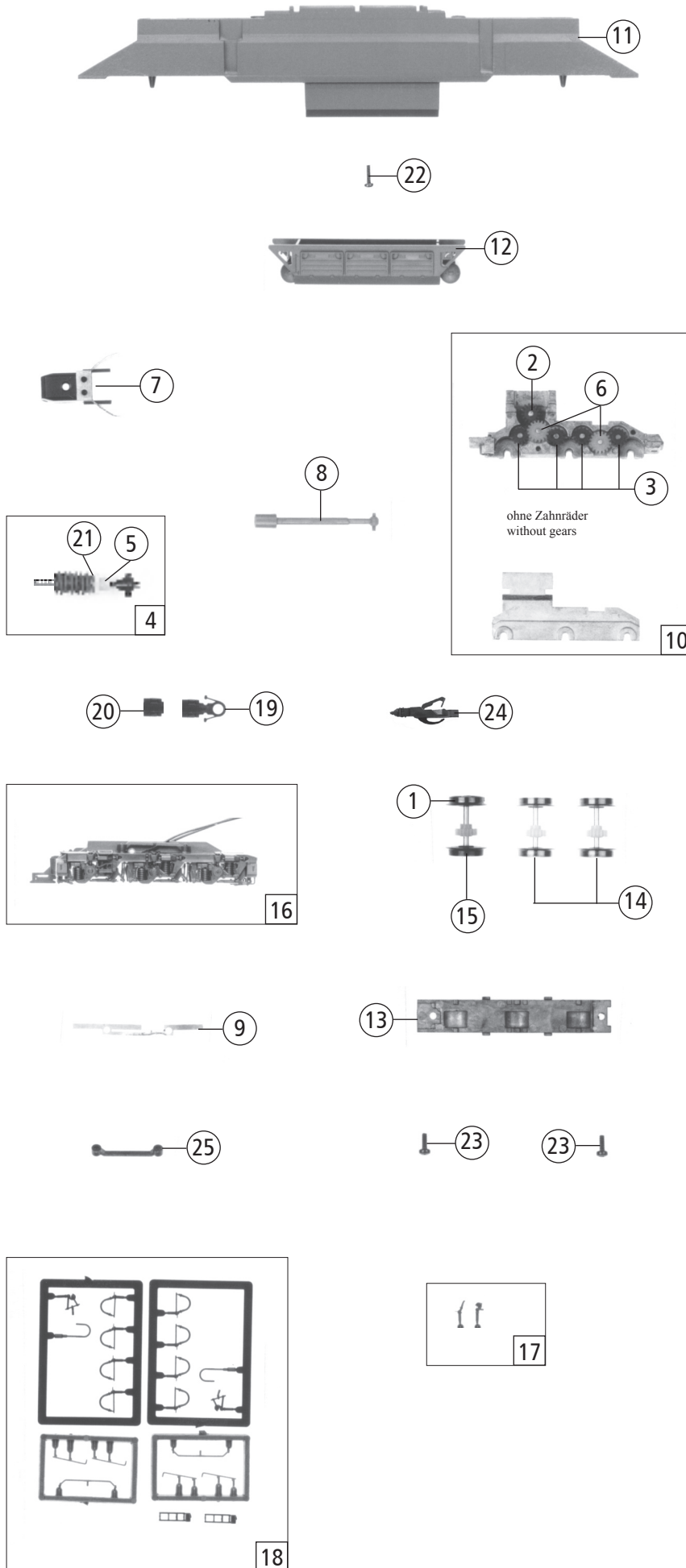

36225		DBAG	BR 232	=	
Pos. Nr. Pos. no.	Beschreibung Description	Art.-Nr. Art. no.	Preisgruppe Price bracket		
1	Haftring N 8-10mm 0,3 Traction tyre set	85611	17		
2	Schnecken Zahnrad Z=19/14 M=0.3 Gear Z=19/14 M=0.3	86400	3		
3	Zahnrad Z=14 gerade M=0.3 rot Gear Z=14 gerade M=0.3 red	86496	2		
4	Schneckensatz Worm set	86979	24		
5	Schneckenlager Worm axle bearing	89750	4		
6	Zwischenzahnrad Gear between	97738	3		
7	Schneckendeckel Worm cover	108051	8		
8	Kardanwelle Cardan shaft	107646	3		
9	Radkontakt Wheel current contact strip	108045	3		
10	Getriebesatz ohne Zahnräder Gear part set without gears	108048	9		
11	Grundrahmen Frame	109318	23		
12	Tank Tank	127969	3		
13	Getriebeboden Gear bottom	109322	5		
14	Radsatz ohne Haftring Wheelset without traction tyre	109323	16		
15	Radsatz mit 2 Haftringen Wheelset with traction tyre	109324	18		
16	Blende komplett Bogie frame assembly	109325	23		
17	Bremsschlauch+Kupplungshaken Air-brake hose and coupling hook	109329	2		
18	Zurüstbeutel Bag with accessories	109330	15		
19	Kupplungskammer Coupling holder	109331	2		
20	Kupplungsdeckel Coupling cover	109332	2		
21	Scheibe Disc	112394	3		
22	Schraube M1.6x6 Screw M1.6x6	113069	2		
23	GF-Schraube M1.6X4 GF-Screw M1.6x4	114850	2		
24	TT - Kupplung o. Abb. TT - Coupling no ill.	124371	6		
25	Kontaktalter Contact holder	124458	2		